

Project Update for the Week of 4/20

CR Construction will be prepping and performing two tie-ins. On Tuesday, April 21st they will do the tie-in at the intersection of NE 24th CT, affecting four homes. Then on Wednesday, April 22nd they will do the tie in at NE 29th ST, which will impact thirty-one homes. Customers will be out of service for these scheduled shutdowns between 8:00 AM to 5:00 PM. Maps are attached showing the affected customers. Door hangers will be placed on April 17th.

During the rest of the week CR Construction will work to connect the remaining four hydrants to the new water main. Another crew will also remove the old water meter setters on areas where the old water main has been decommissioned.

Tuesday Shut Down Map

D03 (I) – Sahalee Drive East & NE 24 CT

| | |
|---------------------------|---|
| # of Valves Turned | 1 |
| # Houses Impacted | 4 |

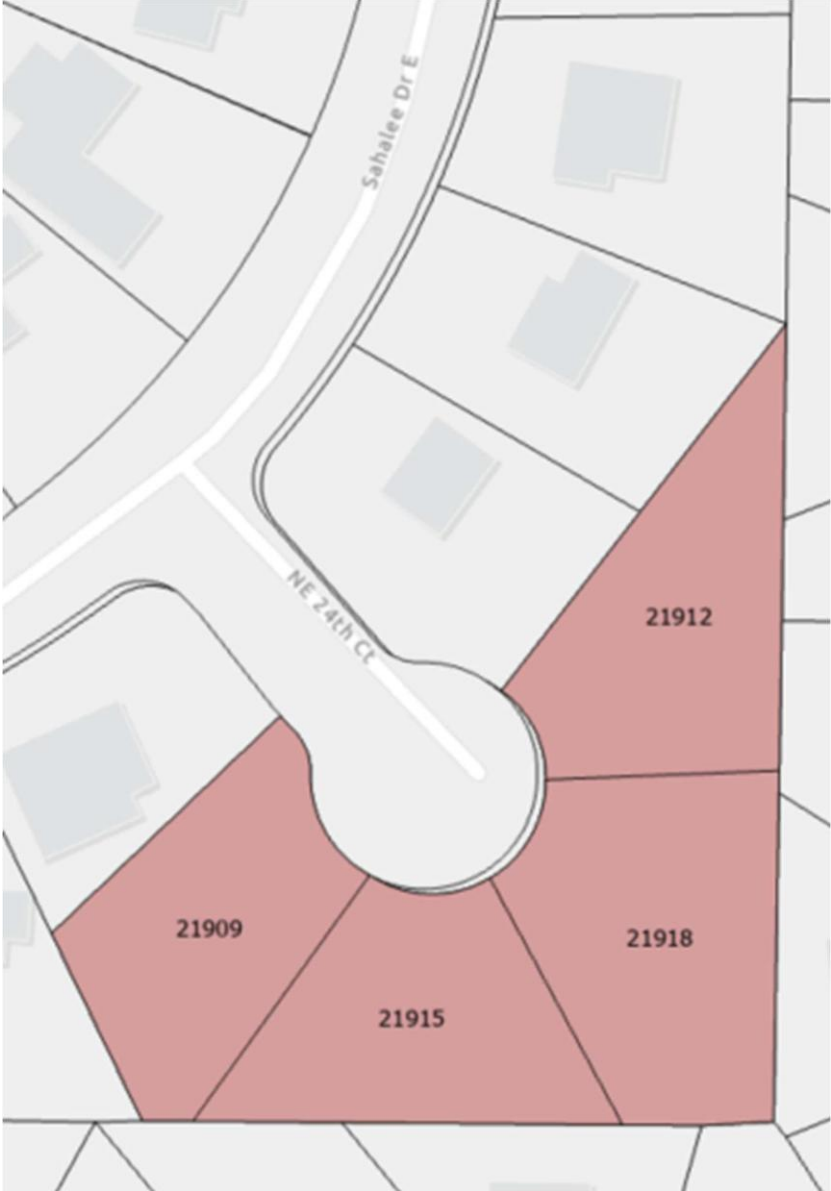

Wednesday Shut Down

**D02 (G) – Sahalee Drive East & NE
29th ST**

| | |
|--------------------------|-----------|
| | 2 |
| # Houses Impacted | 31 |

